



SERVICE PARTS LIST

BULLETIN NO.
54-02-0425

SPECIFY CATALOG NO. AND SERIAL NO. WHEN ORDERING PARTS		REVISED BULLETIN	DATE
6 TON HAND CHAIN HOIST			Oct. 2001
CATALOG NO. 9558, 9559	DATE CODE VG 9408	WIRING INSTRUCTION NONE	

EXAMPLE:
Component Parts (Small #)
Are Included When Ordering
The Assembly (Large #).

00
0

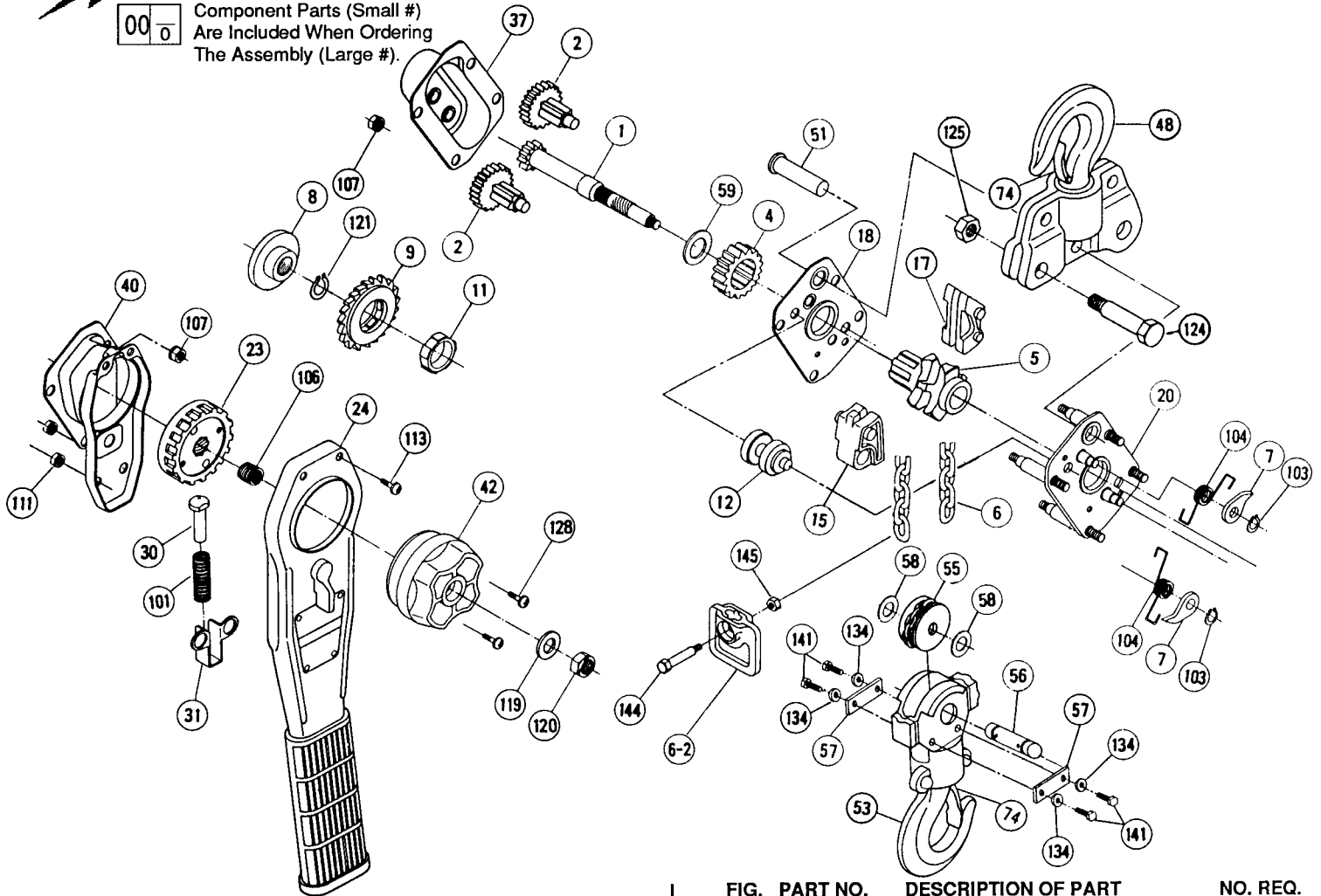

FIG.	PART NO.	DESCRIPTION OF PART	NO. REQ.
1	36-66-0030	Pinion Shaft	(1)
2	32-60-0050	Pinion with Pinion Gear	(2)
4	32-60-0060	Load Gear	(1)
5	45-11-0200	Load Sheave	(1)
6.2	45-52-0030	Stop Grip	(1)
7	44-55-0020	Pawl	(2)
8	43-78-0030	Disc Hub	(1)
9	45-94-0020	Ratchet Wheel	(1)
11	44-90-0320	Interlocking Ring	(1)
12	43-56-0530	Chain Guide	(1)
15	44-77-0030	Stripper	(1)
17	43-56-0540	Chain Guide	(1)
18	44-66-0080	Gear-Side Plate	(1)
20	44-66-6150	Handle-Side Plate	(1)
23	44-40-0075	Disc Nut	(1)
24	43-62-0115	Operating Handle	(1)
30	45-08-0020	Spring Shaft	(1)
31	42-20-0030	Shaft Base	(1)
37	42-92-1020	Gear Cover	(1)
40	42-92-1030	Ratchet Cover	(1)
42	43-62-0040	Guide Handle	(1)
48	43-74-0200	Top Hook Assembly	(1)
51	44-66-1430	Yoke Pin	(1)
53	43-74-0210	Bottom Hook Assembly	(1)
55	45-94-0030	Chain Wheel	(1)
56	44-60-1440	Wheel Pin	(1)
57	44-66-6160	Key Plate	(2)
58	45-88-8660	Wheel Washer	(2)

FIG.	PART NO.	DESCRIPTION OF PART	NO. REQ.
59	45-88-8650	Pinion Shaft Washer	(1)
74	44-20-0380	Safety Latch Assembly	(1)
101	40-50-0050	Change-Over Spring	(1)
103	44-90-0330	Snap Ring	(2)
104	40-50-0120	Pawl Spring	(2)
106	40-50-0130	Free-Wheeling Spring	(1)
107	44-40-0710	Spring Nut	(8)
111	44-40-0085	Spring Nut	(2)
113	45-88-8620	Screw & Spring Washer	(2)
119	45-88-8630	Flat Washer	(1)
120	44-40-0045	Lock Nut	(1)
121	44-90-0010	Snap Ring	(1)
124	42-32-0290	Chain Fastening Bolt	(1)
125	44-40-0730	Lock Nut	(1)
128	45-88-8640	Screw & Spring Washer	(2)
134	45-88-8670	Spring Washer (For 141)	(4)
141	42-32-0300	Hexagon Bolt	(4)
144	42-32-0280	Socket Bolt	(1)
145	44-40-0175	Lock Nut	(1)

FIG.	PART NO.	DESCRIPTION OF PART	NO. REQ.
		(For Catalog 9558 Only)	
	12-40-0126	Nameplate	(1)
6	42-60-0115	6 Ton 5 Ft. Load Chain	(1)
		(For Catalog 9559 Only)	
	12-40-0131	Nameplate	(1)
6	42-60-0125	6 Ton 20 Ft. Load Chain	(1)

MILWAUKEE ELECTRIC TOOL CORPORATION
13135 W. LISBON RD., BROOKFIELD, WI 53005